

- 14GA 2 x 2" STEEL TUBE CONSTRUCTION TYPICAL
- ASSEMBLY REQUIRED
- SEE PRICE LIST FOR ADDITIONAL PART NUMBERS
- AVAILABLE SEPARATELY-
 - UPRIGHT POST KIT WITH HORIZONTAL SUPPORTS (SHOWN)
 - 12" DEEP SHELF KIT (SHOWN WITH 2 SHELF KITS)
 - CHEM RESISTANT PHENOLIC WORKSURFACE, 3/4" (SHOWN)
 - SIDE APRON TO ACCOMMODATE 36" DEEP CUSTOM WORKSURFACE
 - SINGLE SUSPENDED DRAWER
 - 3" DIA STEM SWIVEL CASTER KIT W/BRAKE
 - 24.75" DEEP LOWER SHELF W/BRACKETS (SHOWN)
 - SAFETY DIVIDER KITS; SIDE AND REAR, 1/4" ACRYLIC

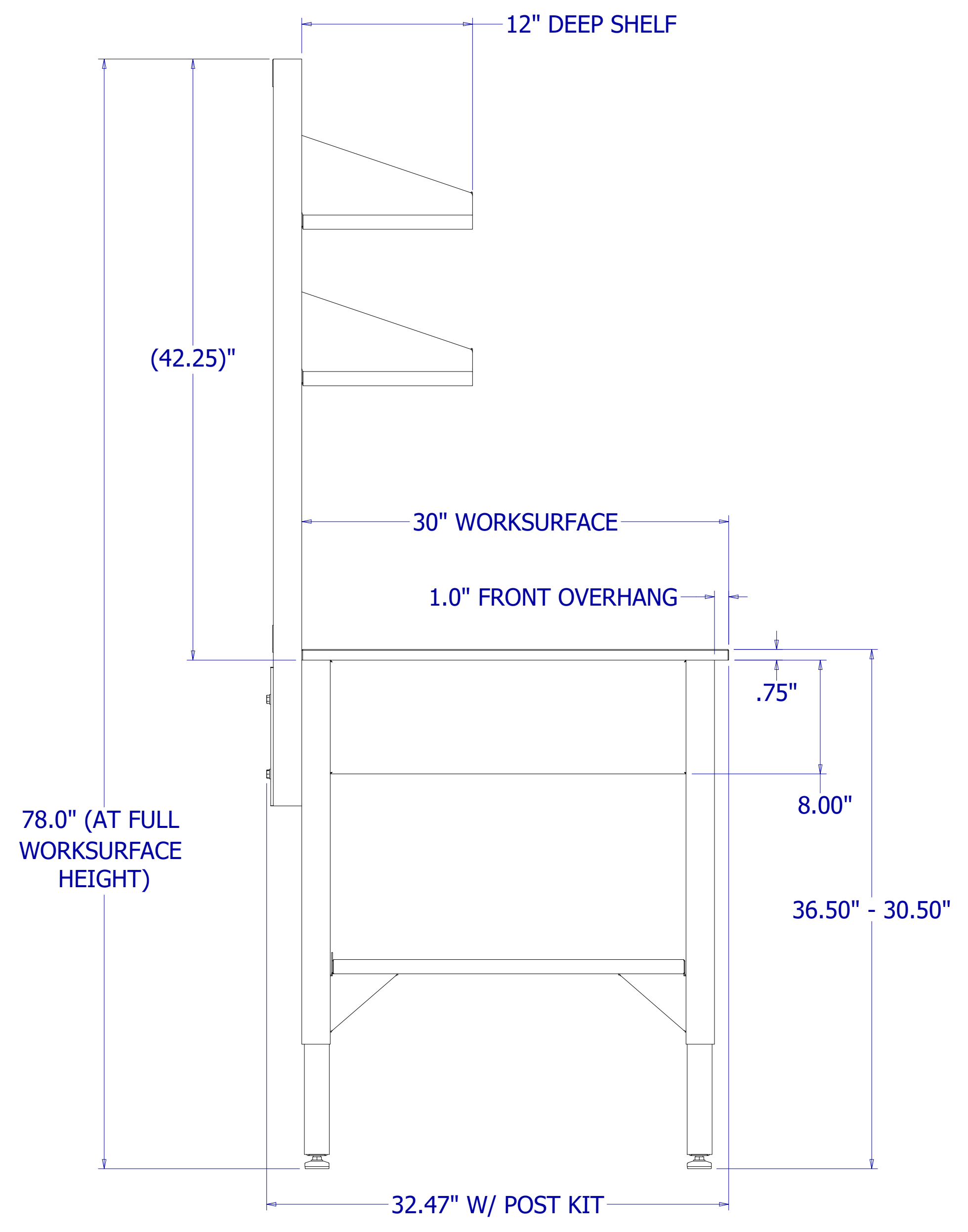

LL4830CRP: 48x30 PHENOLIC TOP
LL7230CRP: 72x30 PHENOLIC TOP

STANDARD SIZE MATRIX		
Table size	Frame width	Worksurface width
48 x 30	47-3/4"	48"
72 x 30	71-3/4"	72"

DRAWN	4/20/2020	LOOPED LOGIC		
MWR		747 Calle Plano, Camarillo CA 93012 866-340-2622		
CHECKED		TITLE		
QA		CUT SHEET, LOOPED LOGIC UTILITY TABLE, ADJ HT		
		FINISH		
		PETAL WHITE		
APPROVED		SIZE	PART NO	REV
		D		A
UNLESS OTHERWISE NOTED, GEN. TOLERANCE +/- .015"; ALL DIMENSIONS ARE IN INCHES	JOB #	SCALE	.15 MATL	SHEET 1 OF 1
	QUOTE #			