

FUME HOODS

Index

Benchtop and floor-mounted, standard or custom, and the fastest delivery in the U.S. The best is within your reach, your budget, and your schedule.

Hanson's hoods have one of the smoothest riding sashes in the industry at surprisingly competitive prices.



Fume Hood Index

Page

Benchtop, floor-mounted, and custom configurations, with the fastest fume hood shipping times in the industry

ABOUT HLS FUME HOODS	137
SASH DESIGNS	138
OPERATING TYPES	140
5SA SERIES – BENCHTOP MOUNT	
• Dimensional Data	141
• General Purpose Hoods	142
• Hi-Line Hoods	143
• ADA Hoods	144
• Choice Sheets	145
4SA SERIES – FLOOR-MOUNT	
• Dimensional Data	147
• Vertical Sash	148
• Horizontal Sash	149
OPTIONS AND ACCESSORIES	
• Base Cabinets	150
• Service Fixtures	151
• Countertops	152
• Electrical, Cupsinks, Lighting	153
• Flow Monitors, Lattice Rod Assemblies	154
• Ceiling Enclosures	155
• Extractor Arms	158
• Canopy Hoods	159



The HLS Advantage.....

With a 50-year history of dedication and experience in the laboratory market, Hanson Lab Solutions delivers a unique new generation of fume hoods, incorporating design excellence and superior safety and performance. Many of Hanson's standard design features are expensive options with other fume hood manufacturers. HLS hoods have been tested to ASHRAE-110-1995 specifications and are UL 1805 Listed, as manufactured.

Features and Benefits

Optimal View Sash Design

36" high safety glass gives you an optimal unobstructed sight line into the fume hood.

Optimal Sash Opening

30" full vertical sash opening for easier setup of lab processes and apparatus.

Stainless Steel Bottom Air Foil

Standard stainless steel flush sill bottom air foil gives you superior corrosion resistance than ordinary painted sills.

Stainless Steel Vented Finger Pull

Standard stainless steel vented sash finger pull provides a smooth sash operation and corrosion resistance.

Outer Access Panels

Removable side access panels on both sides provide easy access for maintenance and for adding additional service fixtures in the future.

Stainless Steel Faceplates

Stainless steel electrical plates, instead of plastic, are provided on electrical switches and receptacles as standard.

Junction Box Receptacle

A standard duplex receptacle is provided on the junction box with prewiring of electrical fixtures.

Stainless Steel Exhaust Collar

A standard stainless steel exhaust collar in lieu of a painted collar is provided for superior corrosion resistance from chemical fumes.

Exterior LED Lighting

Exterior LED lighting is located away from fumes and gives you excellent interior illumination.

Mechanical Sash Stop

Designed to stop the fume hood sash from rising above a certain point. The stop can be overridden to allow the sash to fully open when needed to set up equipment inside the hood. Unless otherwise specified, the stop will be mounted on the left side, at an 18" sash opening.

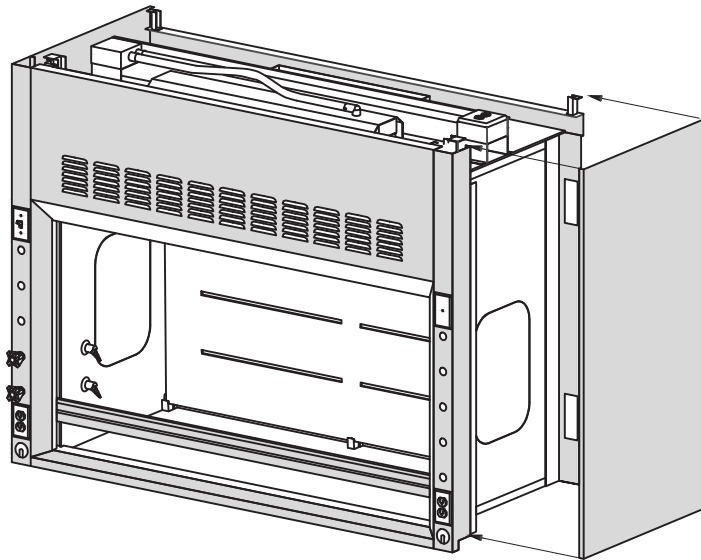

Interior Access Panels

PVC soft-gasket interior access panels on both sides eliminate containment seepage into sidewalls.

Wire Management Chase

Our standard wire management chase system, exclusive on Hanson's benchtop fume hoods, allows you to run cords or tubing into the hood instead of under the glass sash.

Full-Frame Construction

Interior and exterior panels are attached to a full-perimeter epoxy powder-coated steel frame for strength and durability.

Service Fixtures

Unique streamlined Color-Tech service fixtures are epoxy-coated and color-coded to each type of fixture required.

FUME HOODS

Sash Designs

Vertical Rising Sash

- Standard feature on HLS Benchtop and Floor-Mounted hoods
- Frameless sash with laminated safety glass and vented finger pull
- 30-1/2" high sash opening with a 36" high sight line
- Stainless steel flush sill bottom air foil
- NOTE: Hoods wider than 96" will feature a Split Sash (-SPS; see below)

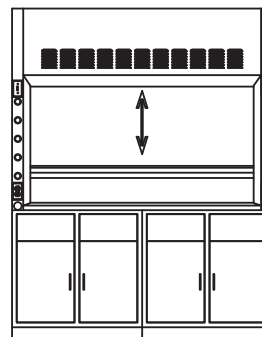

Combination Sash - Horizontal / Vertical (optional)

- Incorporates both a vertical rising sash and a horizontal sliding sash.
- Check with your HLS representative to see how many horizontal panels are provided with each size fume hood
- To specify a combination sash design, add -CS at the end of the fume hood model number

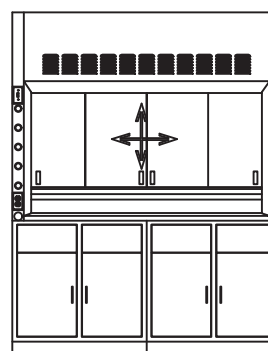

Model

-CS

SPS - Split Sash (optional)

- Two independent vertical sashes open on a post-less track design
- To specify a split sash, specify -SPS at the end of the fume hood model number
- Maximum sash opening on Split-Sash fume hoods is 28"
- Only available on 72, 96", 120", & 144" fume hoods

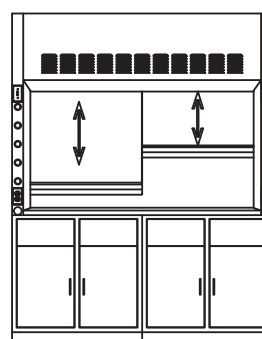

Model

-SPS

HS - Horizontal Sliding Sash (optional)

- Uses sliding horizontal sash panels instead of vertical rising panels
- Check with your HLS representative to see how many horizontal panels are provided with each size fume hood
- To specify a horizontal sash, add -HS at the end of the fume hood model number

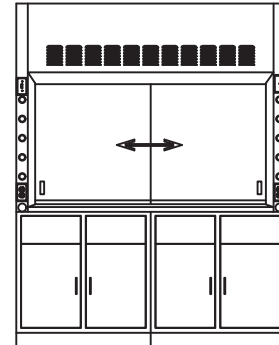

Model
-HS

FUME HOODS

Operating Types

- Constant Air Volume - Standard HLS configuration
- Designed for constant rate of exhaust
- Variable Air Volume (specify -VAV at the end of the hood part number ex. 5SA72B-VAV)
- Designed to limit the bypass area, typically used in conjunction when VAV exhaust systems are installed on the building's HVAC system
- VAV is a type of fume hood exhaust system that typically maintains constant fume hood face velocity by adjusting blower motor speed or a balance damper in response to changes in the sash position

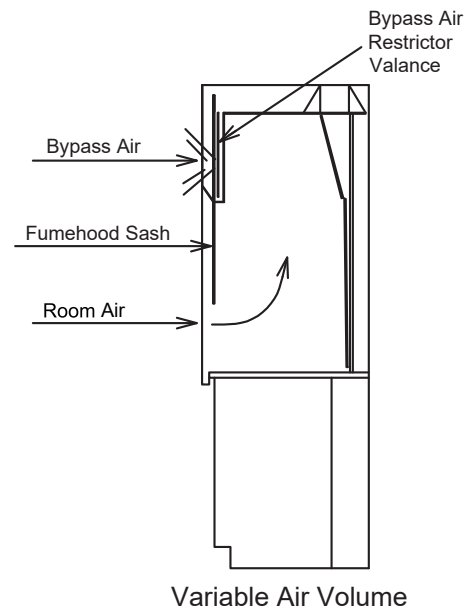
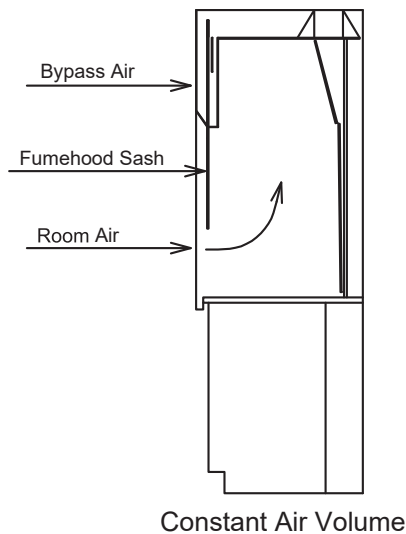

FUME HOODS – 5SA SERIES: BENCHTOP MOUNT



Dimensional Data

hansonlab.com • 805-498-3121

- Fume hoods are shown with HLS standard construction.
- Fume hood standard electrical package is shown with optional factory prewiring to a junction box located on the top of the hood
- A complete selection of options and accessories are located in the HLS fume hood section
- Contact your HLS representative for custom designs or other fume hood information

The dimensions shown are for the following 5SA Series fume hoods:

- General Purpose Bench Top Hoods
- Hi-Line Bench Top Hoods
- ADA Bench Top Hoods

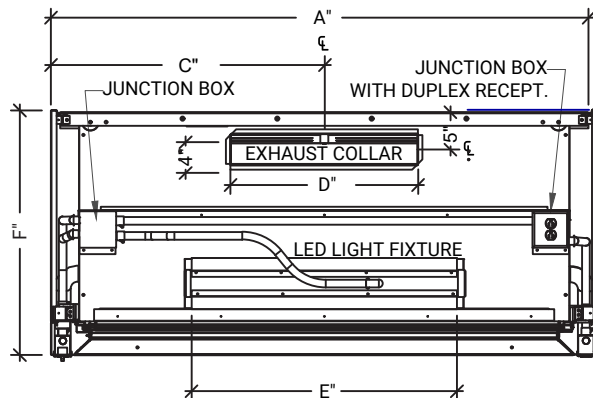

Top View

5SA Series Dimensional Chart

Model	A	B	C	D	E
5SA48A	48"	38"	23.5"	24"	24"
5SA60A	60"	50"	29"	24"	36"
5SA72A	72"	62"	35"	24"	36"
5SA96A	96"	86"	47"	36"	24" x 2
5SA120A	120"	110"	*2@31.8"	24" x 2	36" x 2
5SA48B	48"	38"	23.5"	24"	24"
5SA60B	60"	50"	29"	24"	36"
5SA72B	72"	62"	35"	24"	36"
5SA96B	96"	86"	47"	36"	24" x 2
5SA120B	120"	110"	*2@31.8"	24" x 2	36" x 2
5SA48C	48"	38"	23.5"	24"	24"
5SA60C	60"	50"	29"	24"	36"
5SA72C	72"	62"	35"	24"	36"
5SA96C	96"	86"	47"	36"	24" x 2
5SA120C	120"	110"	*2@31.8"	24" x 2	36" x 2

*Center line of collars from either end

Model	F	G	H	I	J
5SA-A	31-3/8"	26.113"	23-1/2"	22"	19-1/2"
5SA-B	37-3/8"	26.113"	29-1/2"	28"	25-1/2"
5SA-C	41-3/8"	35-7/8"	33-1/2"	32"	29-1/2"

Note: "G" dimensions represent the water service fixture for cup sinks located at the back.

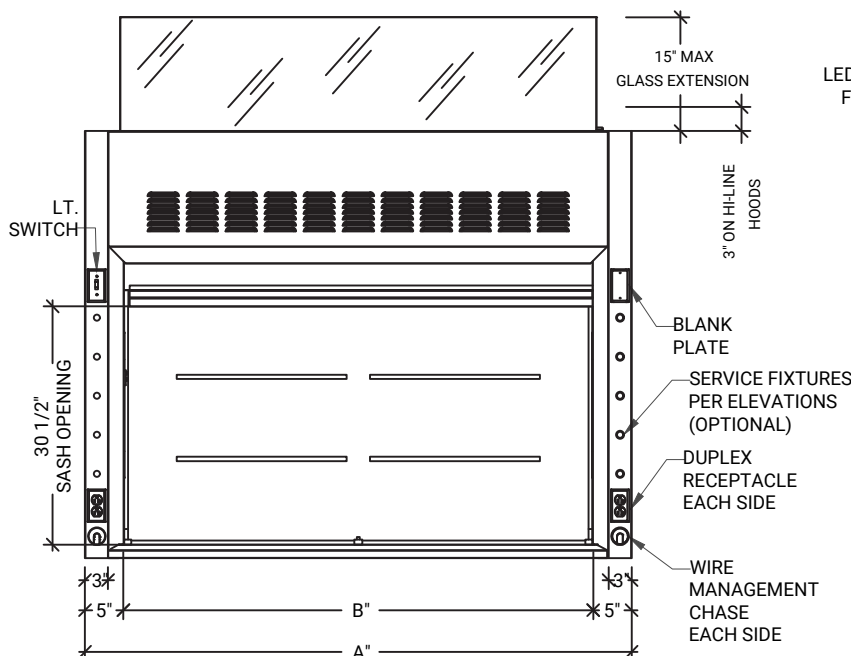

Front View

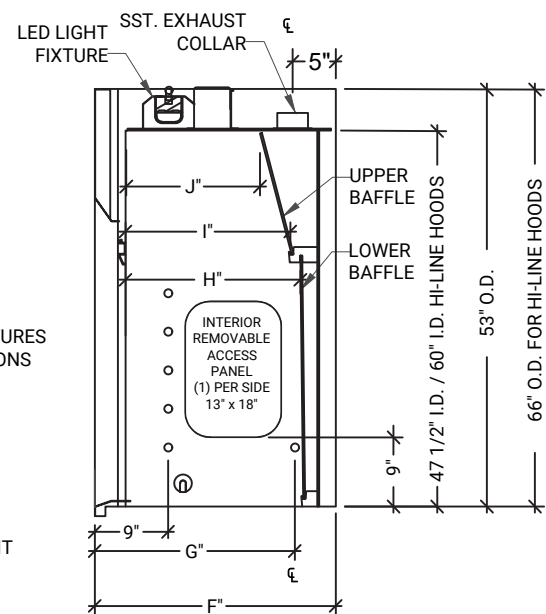

End View

FUME HOODS – 5SA SERIES: BENCHTOP MOUNT

General Purpose

Constant Volume Bypass - Vertical Sash

- General purpose chemical fume hood
- Standard electrical package includes a vapor-proof LED light, light switch, and two 120V duplex receptacles
- Stainless steel flush sill bottom air foil
- 30-1/2" high sash opening with a 36" high sight line
- Frameless sash with laminated safety glass and vented finger pull
- Removable interior and exterior panels for access to service valves
- A wire management chase is provided on both sides of the fume hood
- Poly-resin glastic white interior liner
- UL 1805 Listed and meets ASHRAE 110-95 tests as manufactured

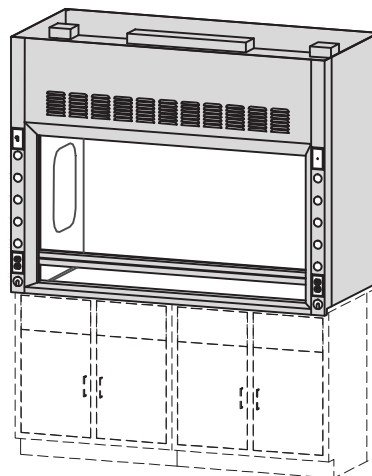

Base Cabinets are optional

Product Model Numbers

Width	"A" Depth 31-3/8"	"B" Depth 37-3/8"	"C" Depth 41-3/8"	Height
48"	5SA48A	5SA48B	5SA48C	53"
60"	5SA60A	5SA60B	5SA60C	53"
72"	5SA72A	5SA72B	5SA72C	53"
96"	5SA96A	5SA96B	5SA96C	53"
120"	5SA120A	5SA120B	5SA120C	53"

Note: 120" wide hoods have a split sash, with two vertical rising sash panels with a maximum 28" high sash opening.

Fume Hood Options and Accessories

- Service Fixtures
- Hood Counter Tops and Sink
- Base and Specialty Cabinets
- Monitors / Alarms (not included on -VAV hoods)
- Ceiling Enclosures
- Pre-piping and Prewiring
- See Accessories pages for more options

Sash Style Options

- Combination Sash -CS
- Split Sash -SPS
- Horizontal Sash -HS

Fume Hood Types

- Variable Air Volume -VAV

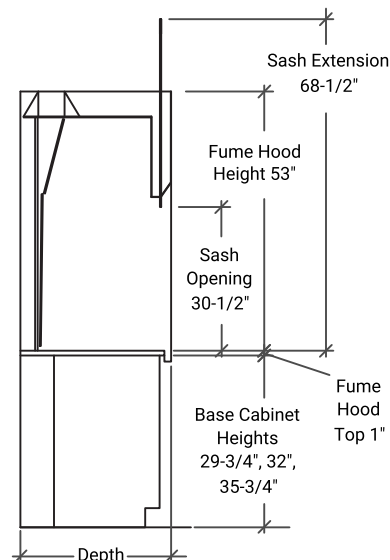

5SA Series CFM Exhaust Volumes .15 S.P.

Fume Hood Width	Exhaust Collar Size	CFM @100 LFM (18" Sash Opening)	CFM @100 LFM (30-1/2" Sash Opening)
48"	4" x 24"	475	790
60"	4" x 24"	600	1020
72"	4" x 24"	750	1300
94"	4" x 36"	1050	1800
120"	(2) 4" x 24"	1400 [Ⓐ]	1075 [Ⓑ]

[Ⓐ] CFM is calculated with both split sashes open at 18"

[Ⓑ] CFM is calculated with one side of split sash fully open at 28" high

CFM = Cubic Feet Per Minute

LFM = Linear Feet Per Minute

FUME HOODS – 5SA SERIES: BENCHTOP MOUNT



Hi-Line

hansonlab.com • 805-498-3121

Constant Volume Bypass - Vertical Sash

- 66" high for extra interior height to accommodate apparatus up to 60" high
- Standard electrical package includes a vapor-proof LED light, light switch, and two 120V duplex receptacles
- Stainless steel flush sill bottom air foil
- 30-1/2" high sash opening with a 36" high sight line
- Frameless sash with laminated safety glass and vented finger pull
- Removable interior and exterior panels for access to service valves
- A wire management chase is provided on both sides of the fume hood
- Poly-resin glastic white interior liner
- UL 1805 Listed and meets ASHRAE 110-95 tests as manufactured

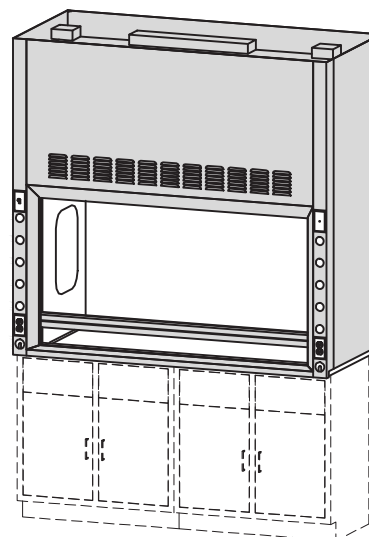

Base Cabinets are optional

Product Model Numbers

Width	"A" Depth 31-3/8"	"B" Depth 37-3/8"	"C" Depth 41-3/8"	Height
48"	5SA48A-HL	5SA48B-HL	5SA48C-HL	66"
60"	5SA60A-HL	5SA60B-HL	5SA60C-HL	66"
72"	5SA72A-HL	5SA72B-HL	5SA72C-HL	66"
96"	5SA96A-HL	5SA96B-HL	5SA96C-HL	66"
120"	5SA120A-HL	5SA120B-HL	5SA120C-HL	66"

Note: 120" wide hoods have a split sash, with two vertical rising sash panels with a maximum 28" high sash opening.

Fume Hood Options and Accessories

- Service Fixtures
- Hood Counter Tops and Sink
- Base and Specialty Cabinets
- Monitors / Alarms (not included on -VAV hoods)
- Ceiling Enclosures
- Pre-piping and Pre-wiring
- See Accessories pages for more options

Sash Style Options

- Combination Sash -CS
- Split Sash -SPS
- Horizontal Sash -HS

Fume Hood Types

- Variable Air Volume -VAV

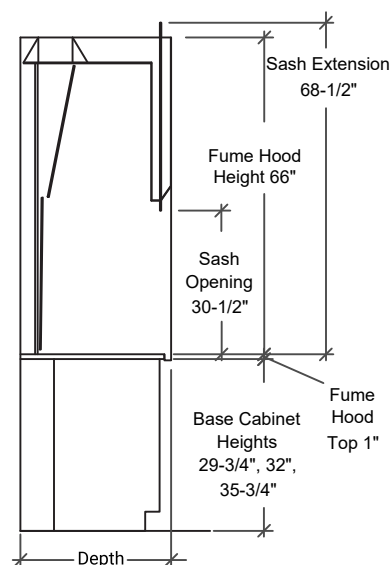

5SA Series CFM Exhaust Volumes .15 S.P.

Fume Hood Width	Exhaust Collar Size	CFM @100 LFM (18" Sash Opening)	CFM @100 LFM (30-1/2" Sash Opening)
48"	4" x 24"	475	790
60"	4" x 24"	600	1020
72"	4" x 24"	750	1300
96"	4" x 36"	1050	1800
120"	(2) 4" x 24"	1400 Ⓐ	1075 Ⓑ

Ⓐ CFM is calculated with both split sashes open at 18".

Ⓑ CFM is calculated with one side of split sash fully open at 28" high

CFM = Cubic Feet Per Minute

FUME HOODS – 5SA SERIES: BENCHTOP MOUNT

ADA

Constant Volume Bypass - Vertical Sash

- Designed to meet guidelines of the American Disabilities Act (ADA)
- Electrical and optional service fixtures are located within reach of wheelchair-bound operators
- Standard electrical package includes a vapor proof LED light, light switch / 120V receptacle, and one 120V duplex receptacle
- Stainless steel flush sill bottom air-foil
- 30-1/2" high sash opening with a 36" high sight line
- Frameless sash with laminated safety glass and vented finger pull
- Removable interior and exterior panels for access to service valves
- A wire management chase is provided on both sides of the fume hood
- Poly-resin glastic white interior liner
- UL 1805 Listed and meets ASHRAE 110-95 tests as manufactured

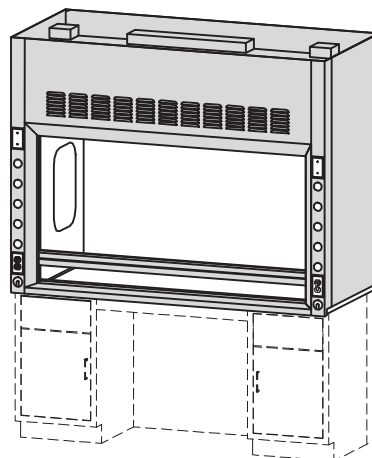

Base Cabinets are optional

Product Model Numbers

Width	"A" Depth 31-3/8"	"B" Depth 37-3/8"	"C" Depth 41-3/8"	Height
48"	5SA48A-ADA	5SA48B-ADA	5SA48C-ADA	53"
60"	5SA60A-ADA	5SA60B-ADA	5SA60C-ADA	53"
72"	5SA72A-ADA	5SA72B-ADA	5SA72C-ADA	53"
96"	5SA96A-ADA	5SA96B-ADA	5SA96C-ADA	53"

Fume Hood Options and Accessories

- Service Fixtures
- Hood Counter Tops and Sink
- Base and Specialty Cabinets
- Monitors / Alarms (not included on -VAV hoods)
- Ceiling Enclosures
- Pre-piping and Pre-wiring
- See Accessories pages for more options

Sash Style Options

- Combination Sash -CS
- Split Sash -SPS
- Horizontal Sash -HS

Fume Hood Types

- Variable Air Volume -VAV

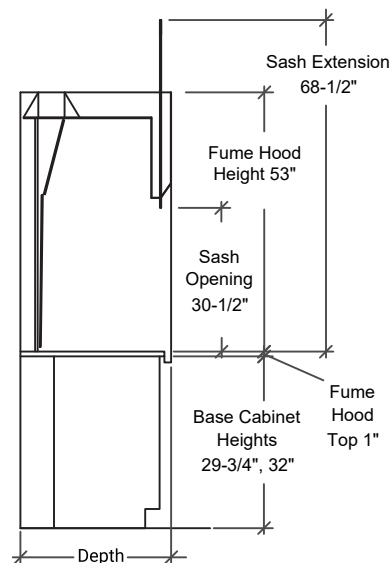

5SA Series CFM Exhaust Volumes .15 S.P.

Fume Hood Width	Exhaust Collar Size	CFM @100 LFM (18" Sash Opening)	CFM @100 LFM (30-1/2" Sash Opening)
48"	4" x 24"	475	790
60"	4" x 24"	600	1020
72"	4" x 24"	750	1300
96"	4" x 36"	1050	1800

CFM = Cubic Feet Per Minute
LFM = Linear Feet Per Minute

5SA Series Benchtop Mounted Fume Hood Specification Worksheet

Application notes:

- Standard electrical package includes a vapor-proof LED light, light switch, one roof-mounted receptacle and two user-facing 120V duplex receptacles
- Stainless steel flush sill bottom air foil
- Frame-less sash with laminated safety glass and vented finger pull
- Removable interior and exterior panels for access to service valves
- A wire management chase is provided on both sides of the fume hood
- Poly-resin glastic white interior liner
- UL 1805 Listed and meets ASHRAE 110-95 tests as manufactured

Hood Depth:

A - 31-3/8"

B - 37-3/8"

C - 41-3/8"

Service

Service

Service

Service

Service

Monitor / Alarm

Service

Service

Service

Service

Service

Cabinet Height:

35"

32"

29"

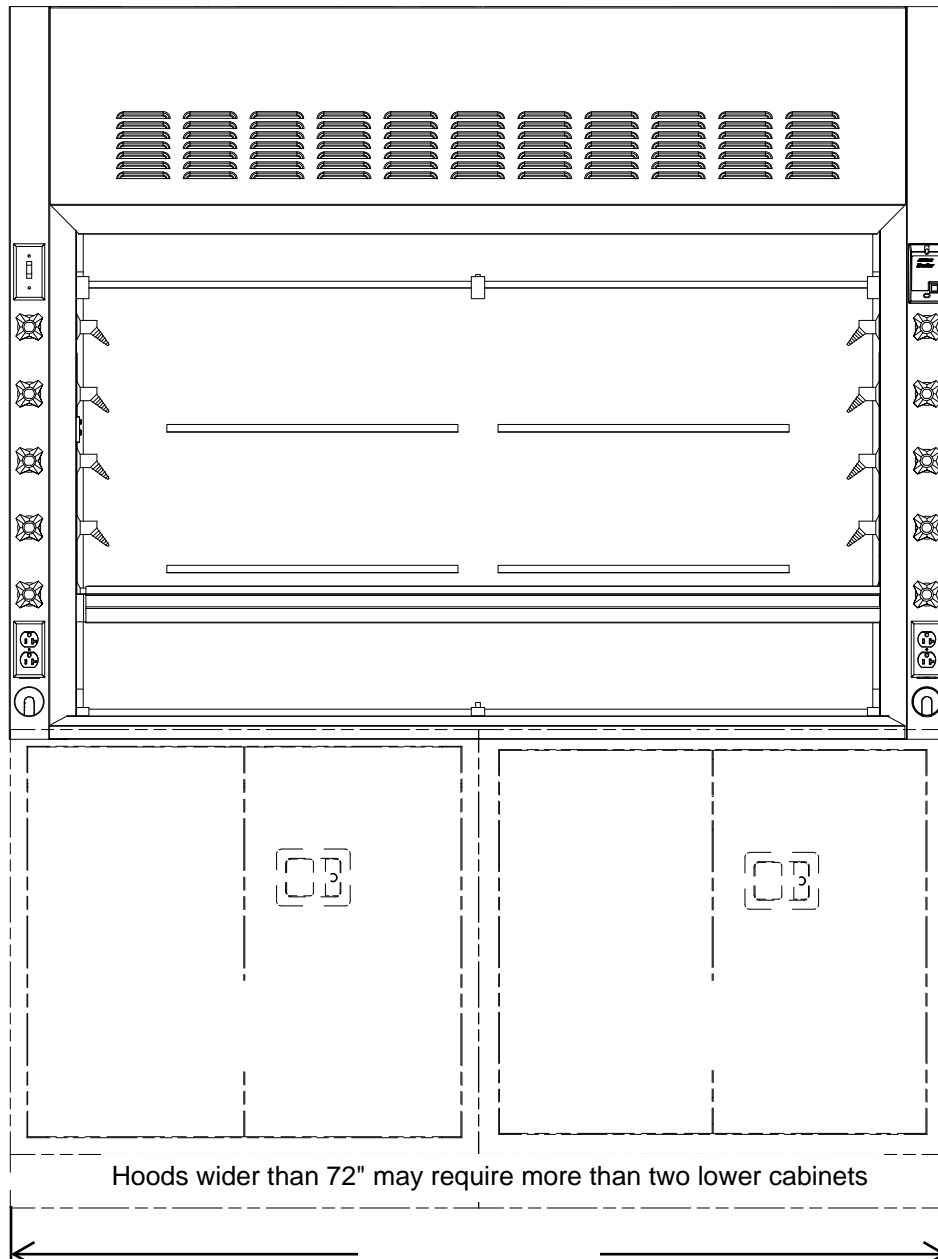

5SA SERIES FUME HOOD ACCESSORIES:

Lattice Assembly:

None
Aluminum Lattice Assembly
Stainless Steel Assembly

Ceiling Enclosure:

Yes No

Ceiling Height:

Finished Back:

Yes No

Interior Lighting Fixture:

Explosion Proof Light

Blower Switch:

Yes No

Single Point Connection:

Yes No

Connection Side:

Right Left

Sash Type:

Vertical Rising Sash

Combination

Split Sash

Horizontal

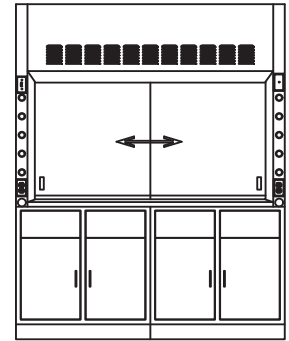
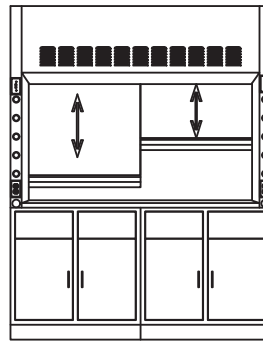
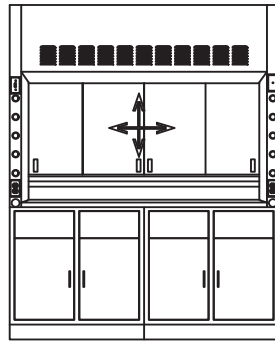
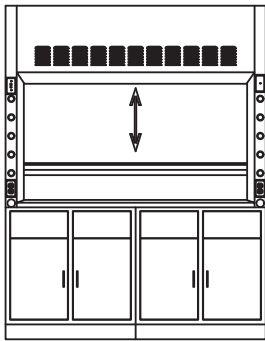

Work Surface Material:

Black Epoxy (standard)

Other Color:

Black Phenolic

Other Color:

Type 304 Stainless Steel

Cup Sink:

Cup Sink:

Yes No



CS4R



TS12

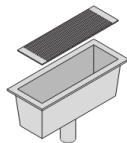

TS18

Cup Sink Cutout Location:

Left Rear Both Rear Right Rear



FUME HOODS – 4SA SERIES: FLOOR-MOUNT



Dimensional Data

hansonlab.com • 805-498-3121

- Fume hoods are shown with HLS standard construction
- Fume hood standard electrical package is shown with optional factory prewiring to a junction box located on the top of the hood
- A complete selection of options and accessories are located in the HLS fume hood section
- Contact your HLS representative for custom designs or other fume hood information

The dimensions shown are for the following 4SA Series fume hoods:

- Floor-Mount Vertical Sash Fume Hoods
- Floor-Mount Horizontal Sash Fume Hoods

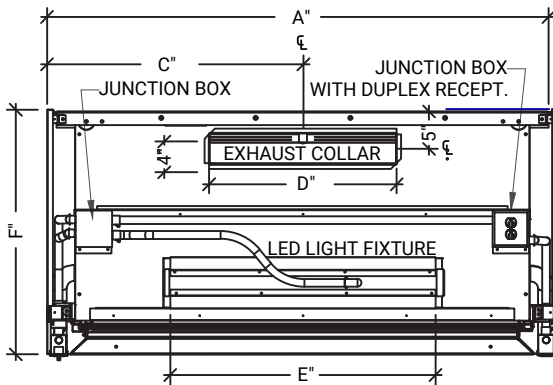

Top View

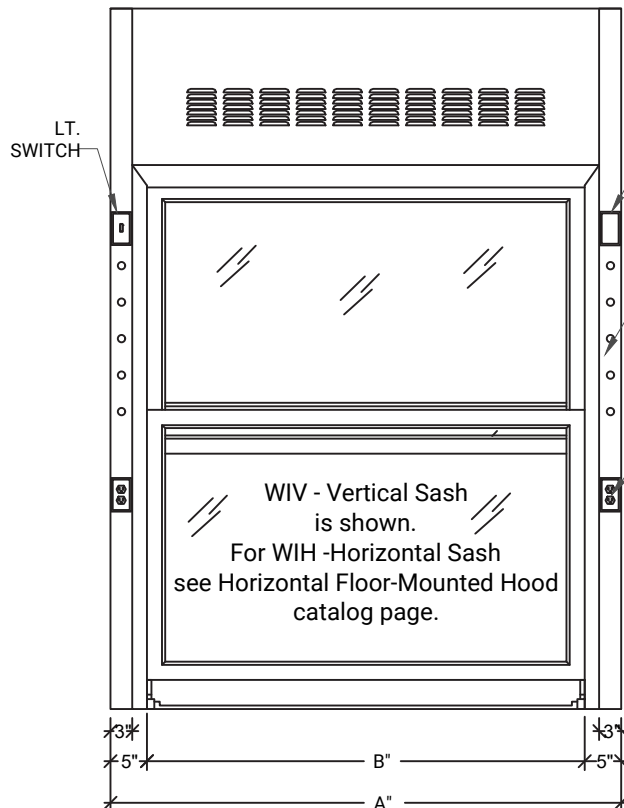

Front View

4SA Series Dimensional Chart

Model	A	B	C	D	E
4SA48A	48"	38"	23.5"	24"	24"
4SA60A	60"	50"	29"	24"	24"
4SA72A	72"	62"	35"	24"	24"
4SA96A	96"	86"	47"	36"	24" x 2
4SA120A	120"	110"	*2@31.8"	24" x 2	36" x 2
4SA48B	48"	38"	23.5"	24"	24"
4SA60B	60"	50"	29"	24"	24"
4SA72B	72"	62"	35"	24"	24"
4SA96B	96"	86"	47"	36"	24" x 2
4SA120B	120"	110"	*2@31.8"	24" x 2	36" x 2

*Center line of collars from either end

Model	F	G	H	I	J
4SA-A	36"	8-3/8"	25-1/2"	24-1/2"	20-1/2"
4SA-B	47-1/2"	19-7/8"	37"	36"	32"

Note: "G" dimensions represent the water service fixture for cup sinks located at the back.

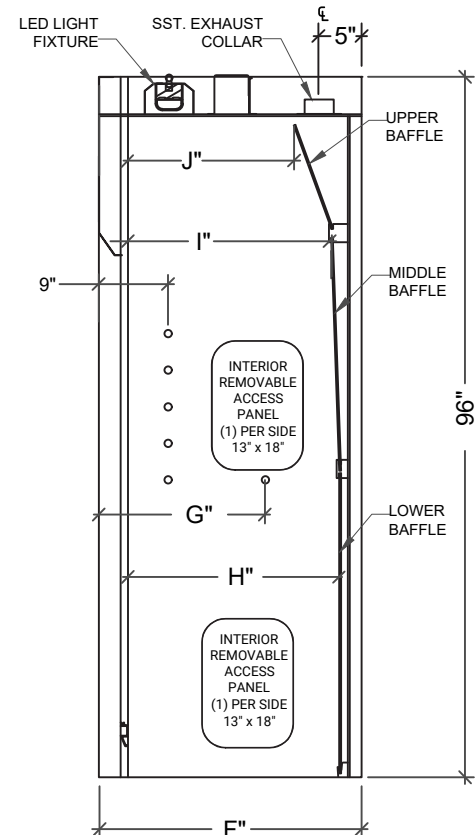

End View

FUME HOODS – 4SA SERIES: FLOOR-MOUNT

Vertical Sash

Constant Volume Bypass - Vertical Sash - WIV

- Designed for large equipment and apparatus
- Standard electrical package includes a vapor-proof LED light, light switch, and two 120V duplex receptacles
- Framed sash with laminated safety glass with vented airfoil design
- Removable interior and exterior panels for access to service valves
- Poly-resin glastic white interior liner
- Floor-Mount fume hoods are shipped knocked down for assembly at job site
- UL 1805 Listed and meets ASHRAE 110-95 tests as manufactured

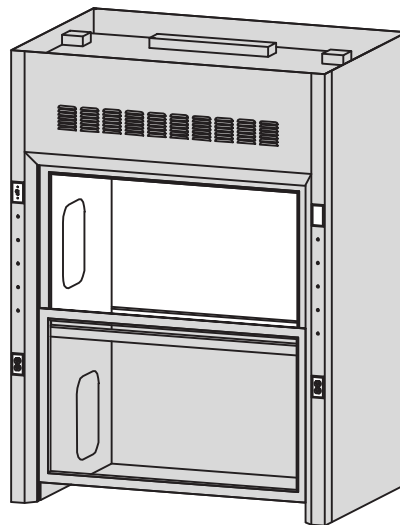

Product Model Numbers

Width	"A" Depth 36" O.D.	"B" Depth 47-1/2" O.D.	Height
48"	4SA48AWIV	4SA48BWIV	96"
60"	4SA60AWIV	4SA60BWIV	96"
72"	4SA72AWIV	4SA72BWIV	96"
96"	4SA96AWIV	4SA96BWIV	96"

Note: For floor-mount hoods ordered with a combination sash, the top inner sash has the horizontal sliding panels.

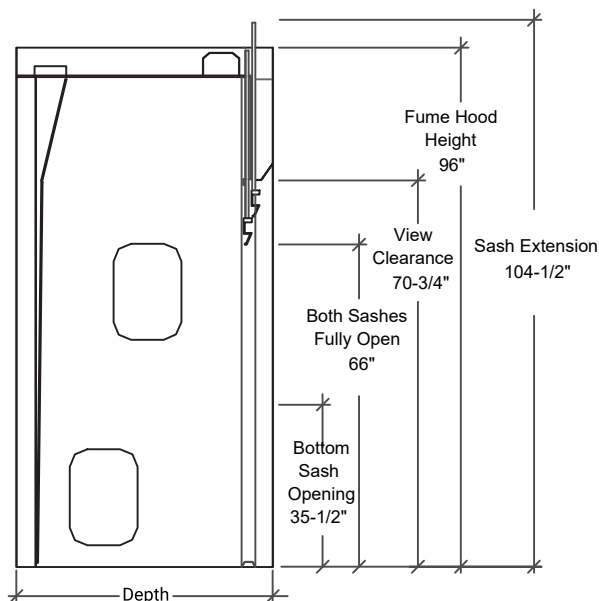

Fume Hood Options and Accessories

- Service Fixtures
- Epoxy Floor
- Panel-mount sink
- Monitors / Alarms (not included on -VAV hoods)
- Ceiling Enclosures
- Pre-piping and Pre-wiring
- See Accessories pages for more options

Sash Style Options

- Combination Sash -CS

Fume Hood Types

- Variable Air Volume -VAV

4SA-WIV Series CFM Exhaust Volumes .15 S.P.

Fume Hood Width	Exhaust Collar Size	CFM @100 LFM (18" Sash Opening)	CFM @100 LFM (One Sash Fully Open - 35-3/4")
48"	4" X 24"	475	975
60"	4" X 24"	600	1250
72"	4" X 24"	750	1600
96"	4" X 36"	1050	2200

CFM = Cubic Feet Per Minute
LFM = Linear Feet Per Minute

FUME HOODS – 4SA SERIES: FLOOR-MOUNT



Horizontal Sash

hansonlab.com • 805-498-3121

Constant Volume Bypass - Horizontal Sash - WIH

- Designed for large equipment and apparatus
- Standard electrical package includes a vapor-proof LED light, light switch, and two 120V duplex receptacles
- Framed sash with laminated safety glass
- Removable interior and exterior panels for access to service valves
- 48", 60", and 72" hoods have two sliding doors
- 96" and 120" hoods have four sliding doors
- 144" hoods have six sliding doors
- Poly-resin glastic white interior liner
- Floor-Mount fume hoods are shipped knocked down for assembly at job site
- UL 1805 Listed and meets ASHRAE 110-95 tests as manufactured

60"	4SA60AWIH	4SA60BWIH	96"	2
72"	4SA72AWIH	4SA72BWIH	96"	2
96"	4SA96AWIH	4SA96BWIH	96"	2
120"	4SA120AWIH	4SA120BWIH	96"	2
144"	4SA144AWIH	4SA144BWIH	96"	2

Product Model Numbers

Width	"A" Depth 36" O.D	"B" Depth 47-1/2" O.D.	Height	Number of Doors
48"	4SA48AWIH	4SA48BWIH	96"	2
60"	4SA60AWIH	4SA60BWIH	96"	2
72"	4SA72AWIH	4SA72BWIH	96"	2
96"	4SA96AWIH	4SA96BWIH	96"	2
120"	4SA120AWIH	4SA120BWIH	96"	2
144"	4SA144AWIH	4SA144BWIH	96"	2

Note: (2) Two sliding door tracks are provided on all sizes of horizontal sash floor-mount fume hoods.

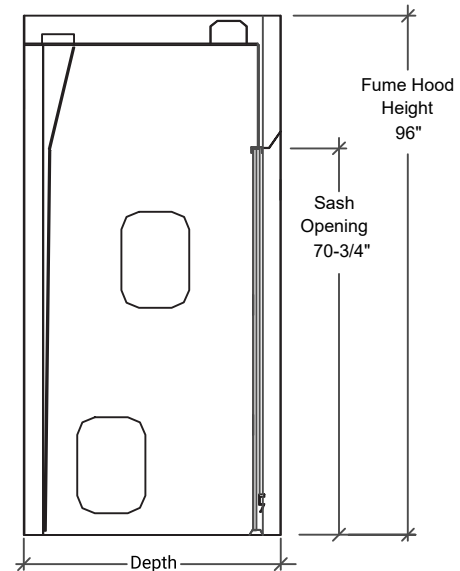
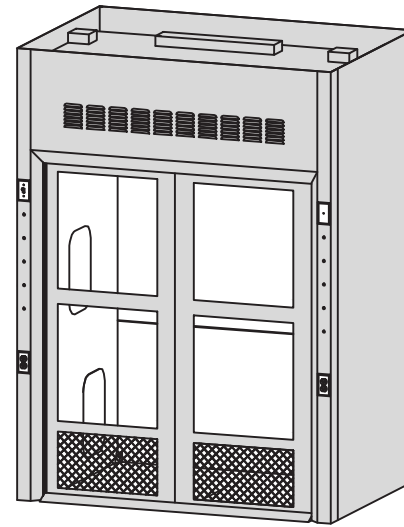

Fume Hood Options and Accessories

- Service Fixtures
- Epoxy Floor
- Panel-mount sink
- Monitors / Alarms (not included on -VAV hoods)
- Ceiling Enclosures
- Pre-piping and Pre-wiring
- See Accessories pages for more options

Fume Hood Types

- Variable Air Volume -VAV

4SA-WIH Series CFM Exhaust Volumes .15 S.P.

Fume Hood Width	Exhaust Collar Size	CFM @100 LFM (18" Sash Opening)	CFM @100 LFM (Full Sash Opening)
48"	4" x 24"	1025	1100
60"	4" x 24"	1075	1400
72"	4" x 24"	1125	1750
96"	4" x 36"	1350	2475
120"	(2) 4" x 24"	1500	3225
144"	(2) 4" x 36"	1650	3950

CFM = Cubic Feet Per Minute
LFM = Linear Feet Per Minute

FUME HOODS

Options & Accessories – Base Cabinets

Fume Hood Cabinet Options

- Base (sink) cabinets are used to support benchtop fume hoods
- Cabinet styles include fume hood cabinets, acid and flammable storage cabinets, and vacuum pump cabinets
- For the complete line of cabinets for fume hoods, see the specialty cabinet section in the base cabinet section of this catalog, starting on page 32.

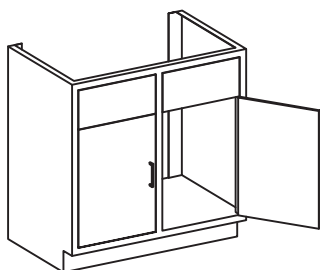
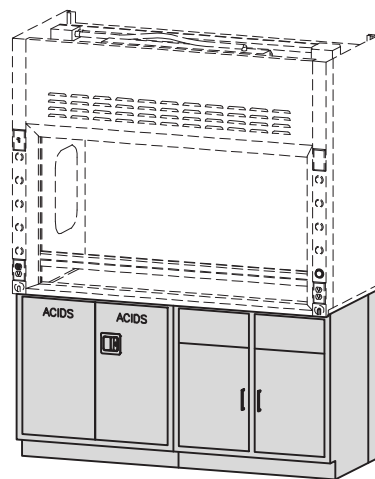

Base Cabinets

(see sink cabinets on pages 18 and 24)

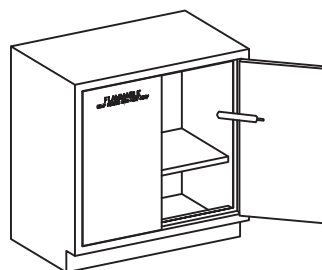

Flammable Cabinets

(see pages 33, 35, 37)

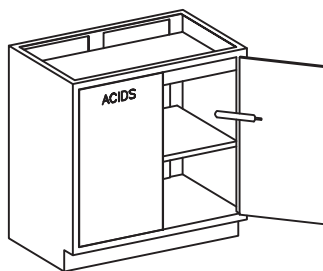

Acid / Base / Corrosive Storage Cabinets

(see pages 32, 34, 36)

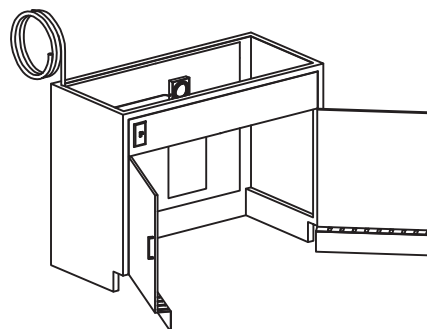

Vacuum Pump Cabinets

(see pages 39-41)

Fume Hood Service Fixtures

- Remote control needle valve with black nylon handle with color coded index button and color coded serrated tip
- Services will be mounted on the fume hood, without internal piping
- Optional pre-piping of service fittings are available (see pre-piping section)

Remote Water Valve

Model	Type
CT3185W-5	Cold Water

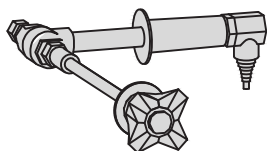

Remote Valves for Air, Gases or Vacuum

Model	Type
CT3185N-LR-AIR	Air
CT3185N-LR-VAC	Vacuum
CT3185N-LR-GAS	Gas
CT3185N-LR-NIT	Nitrogen
CT3185N-LR-AR	Argon

Other specialty gases are available.
Contact your HLS representative for more information.

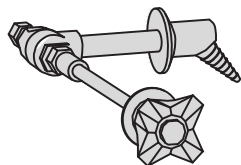

Service Fitting Color Code:

Air.....	Orange
Cold Water.....	Dark Green
Distilled Water.....	White
Gas.....	Dark Blue
Hot Water.....	Red
Argon.....	Violet
Nitrogen.....	Brown
Oxygen.....	Light Green
Special Gases.....	Light Blue
Steam.....	Black
Vacuum.....	Yellow

Remote Water Valve With Gooseneck

Model	Type
CT3185W-9RSVB	Cold Water

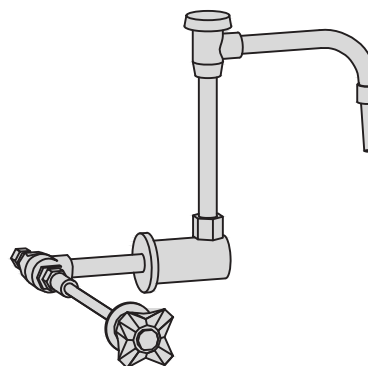

DI Water-panel or Deck Mounted

- Plastic-Lined or Tin-Lined Brass non-remote type
- Left side handles available
- Cannot be factory pre-piped

Model	Type
L7854	Right hand-Panel Mount
L7853	Right hand-Deck Mount

Other Configurations are available.
Contact your HLS representative for more information.

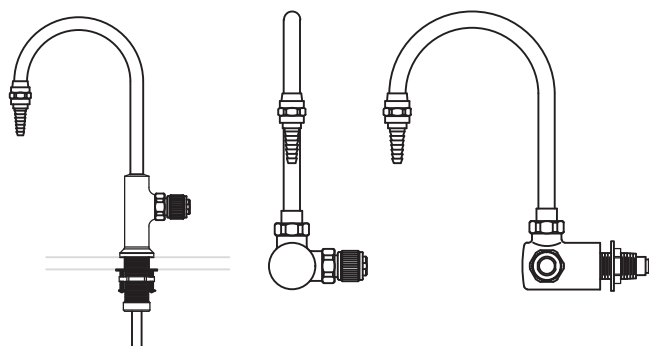

FUME HOODS

Options & Accessories – Countertops

Fume Hood Countertops

- Fume hood tops are 1" thick molded epoxy resin with a 1/4" integrally molded containment area designed to ease cleanups from chemical spills inside the fume hood
- Color: Black Onyx
- Service slots are provided on each side of the fume hood top

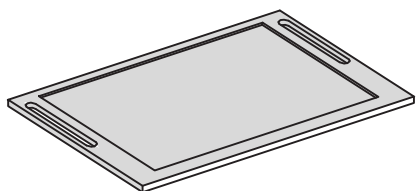

Model	Width	Depth
EHT48A	48"	30"
EHT48B	48"	36"
EHT48C	48"	40"
EHT60A	60"	30"
EHT60B	60"	36"
EHT60C	60"	40"
EHT72A	72"	30"
EHT72B	72"	36"
EHT72C	72"	40"
EHT96A	96"	30"
EHT96B	96"	36"
EHT96C	96"	40"
EHT120A	120"	30"
EHT120B	120"	36"
EHT120C	120"	40"

Fume Hood Countertops w/ Cup Sink Cutout

- Fume hood tops are 1" thick molded epoxy resin with a 1/4" integrally molded containment area designed to ease cleanups from chemical spills inside the fume hood
- Color: Black Onyx
- Service slots are provided on each side of the fume hood top
- Option for cup sink cutout on right, left or both sides of the countertop
- -CRR for cup sink cutout in right rear of the countertop
- -CLR for cup sink cutout in the left rear of the countertop
- -CBR for cup sink cutouts in the left and right rear of countertop

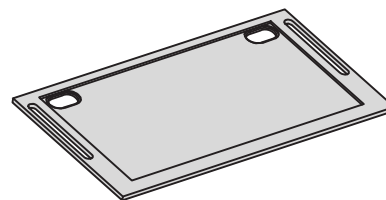

Model	Width	Depth
EHT48A-CBF	48"	30"
EHT48A-CBR	48"	30"
EHT48A-CLR	48"	30"
EHT48A-CRR	48"	30"
EHT48B-CBF	48"	36"
EHT48B-CBR	48"	36"
EHT48B-CLR	48"	36"
EHT48C-CRR	48"	36"
EHT48C-CBF	48"	40"
EHT48C-CBR	48"	40"
EHT48C-CLR	48"	40"
EHT48C-CRR	48"	40"
EHT60A-CBF	60"	30"
EHT60A-CBR	60"	30"
EHT60A-CLR	60"	30"
EHT60A-CRR	60"	30"
EHT60B-CBF	60"	36"
EHT60B-CBR	60"	36"
EHT60B-CLR	60"	36"
EHT60B-CRR	60"	36"

Model	Width	Depth
EHT60C-CBF	60"	40"
EHT60C-CBR	60"	40"
EHT60C-CLR	60"	40"
EHT60C-CRR	60"	40"
EHT72A-CBF	72"	30"
EHT72A-CBR	72"	30"
EHT72A-CLR	72"	30"
EHT72A-CRR	72"	30"
EHT72B-CBF	72"	36"
EHT72B-CBR	72"	36"
EHT72B-CLR	72"	36"
EHT72B-CRR	72"	36"
EHT72C-CBF	72"	40"
EHT72C-CBR	72"	40"
EHT72C-CLR	72"	40"
EHT72C-CRR	72"	40"
EHT96A-CBF	96"	30"
EHT96A-CBR	96"	30"
EHT96A-CLR	96"	30"
EHT96A-CRR	96"	30"

Model	Width	Depth
EHT96B-CBF	96"	36"
EHT96B-CBR	96"	36"
EHT96B-CLR	96"	36"
EHT96B-CRR	96"	36"
EHT96C-CBF	96"	40"
EHT96C-CBR	96"	40"
EHT96C-CLR	96"	40"
EHT96C-CRR	96"	40"
EHT120A-CBF	120"	30"
EHT120A-CBR	120"	30"
EHT120A-CLR	120"	30"
EHT120A-CRR	120"	36"
EHT120B-CBF	120"	36"
EHT120B-CBR	120"	36"
EHT120B-CLR	120"	36"
EHT120B-CRR	120"	36"
EHT120C-CBF	120"	40"
EHT120C-CBR	120"	40"
EHT120C-CLR	120"	40"
EHT120C-CRR	120"	40"

Fume Hood Electrical Options

- All HLS fume hoods have a standard electrical package, which includes two 115V duplex receptacles, LED strip light, and light switch
- Below are other electrical options available

GFI Duplex Receptacles

Model	Type
E113	120V Ground fault protected duplex outlets

Adds one GFI to the existing electrical package

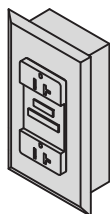

Blower Switch

Model	Type
EMBS	A separate toggle switch to operate the blower / fan, 120V 20A

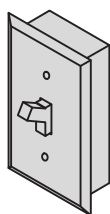

Duplex Receptacles

Model	Type
E2300	120V Single duplex receptacle

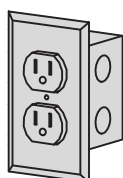

Fume Hood Cup Sinks

- Cup sinks are used as a drain inside the hood
- Made of black polypropylene, cup sinks install in the fume hood countertop or side panel of floor-mounted fume hoods
- Multiple cup sinks and locations can be specified

Panel Mounted

Model	Size
W39027-150	3" x 6" Oval



Counter Mounted

Model	Size
CS4R	3" x 6" Oval



Explosion-Resistant Light

Model	Type
HAL-48-2L	Explosion-resistant fluorescent light is mounted inside of the hood

Cannot be factory prewired

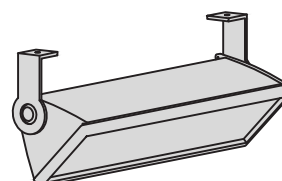

FUME HOODS

Options & Accessories – Flow Monitors, Lattice Rod Assemblies

Air Flow Monitor / Alarm

- Continuously monitors airflow velocity using internal sensors measuring fume hood pressure
- Visual and audible alarm sounds when hood sash height is in an unsafe mode
- Airflow monitors are factory installed
- Contact your HLS representative for full specifications on models available

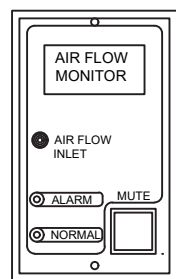

Model E153B
LED lights signal both alarm and normal operating modes

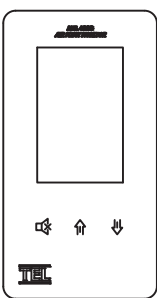

Model E216
Maintains constant digital display of fume hood face velocities - configurable visual and audible alarms

Fume Hood Lattice Rod Assemblies

- Solid 1/2" aluminum rod assemblies consisting of horizontal and vertical rods, adjustable clamps, and mounting flanges used to support apparatus inside the fume hood
- Parts are shipped loose for assembly and installation at the job site

Model	Style	F.H. Size
AAP48	Benchtop	48"
AAP60	Benchtop	60"
AAP72	Benchtop	72"
AAP96	Benchtop	96"
AAP120	Benchtop	120"
AAP48WI	Floor-Mounted	48"
AAP60WI	Floor-Mounted	60"
AAP72WI	Floor-Mounted	72"
AAP96WI	Floor-Mounted	96"
AAP120WI	Floor-Mounted	120"
AAP144WI	Floor-Mounted	144"

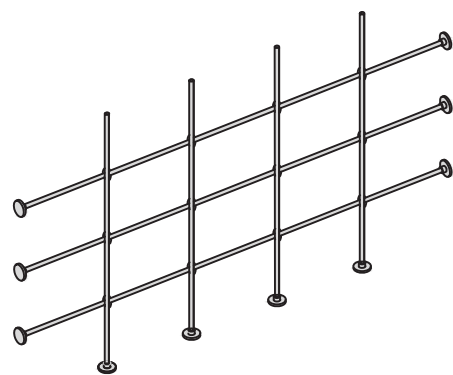

Fume Hood Ceiling Enclosures

- Provides a finished appearance and encloses the space from the top of the fume hood to the ceiling
- A removable front panel is provided for access
- Enclosure heights can be field trimmed as required
- Finished to match the fume hood

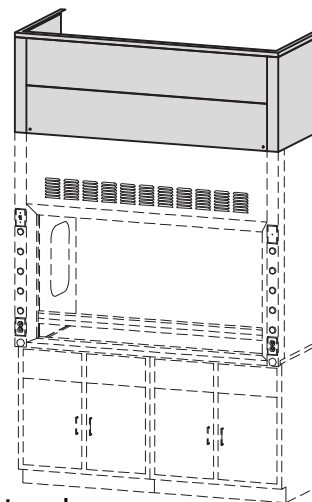

Ceiling Enclosures 5SA Benchtop Fume Hoods

Note: A verified ceiling height is required for manufacturing the correct height of enclosure

Model	Width	Depth	Height	Model	Width	Depth	Height	Model	Width	Depth	Height
CE48A-18	48"	31-3/8"	18.25"	CE60A-18	60"	31-3/8"	18.25"	CE72A-18	72"	31-3/8"	18.25"
CE48A-22	48"	31-3/8"	22.00"	CE60A-22	60"	31-3/8"	22.00"	CE72A-22	72"	31-3/8"	22.00"
CE48A-24	48"	31-3/8"	24.25"	CE60A-24	60"	31-3/8"	24.25"	CE72A-24	72"	31-3/8"	24.25"
CE48A-28	48"	31-3/8"	28.00"	CE60A-28	60"	31-3/8"	28.00"	CE72A-28	72"	31-3/8"	28.00"
CE48A-30	48"	31-3/8"	30.25"	CE60A-30	60"	31-3/8"	30.25"	CE72A-30	72"	31-3/8"	30.25"
CE48A-34	48"	31-3/8"	34.00"	CE60A-34	60"	31-3/8"	34.00"	CE72A-34	72"	31-3/8"	34.00"
CE48A-36	48"	31-3/8"	36.25"	CE60A-36	60"	31-3/8"	36.25"	CE72A-36	72"	31-3/8"	36.25"
CE48A-42	48"	31-3/8"	42.25"	CE60A-42	60"	31-3/8"	42.25"	CE72A-42	72"	31-3/8"	42.25"
CE48A-46	48"	31-3/8"	46.00"	CE60A-46	60"	31-3/8"	46.00"	CE72A-46	72"	31-3/8"	46.00"
CE48A-48	48"	31-3/8"	48.25"	CE60A-48	60"	31-3/8"	48.25"	CE72A-48	72"	31-3/8"	48.25"
CE48B-18	48"	37-3/8"	18.25"	CE60B-18	60"	37-3/8"	18.25"	CE72B-18	72"	37-3/8"	18.25"
CE48B-22	48"	37-3/8"	22.00"	CE60B-22	60"	37-3/8"	22.00"	CE72B-22	72"	37-3/8"	22.00"
CE48B-24	48"	37-3/8"	24.25"	CE60B-24	60"	37-3/8"	24.25"	CE72B-24	72"	37-3/8"	24.25"
CE48B-28	48"	37-3/8"	28.00"	CE60B-28	60"	37-3/8"	28.00"	CE72B-28	72"	37-3/8"	28.00"
CE48B-30	48"	37-3/8"	30.25"	CE60B-30	60"	37-3/8"	30.25"	CE72B-30	72"	37-3/8"	30.25"
CE48B-34	48"	37-3/8"	34.00"	CE60B-34	60"	37-3/8"	34.00"	CE72B-34	72"	37-3/8"	34.00"
CE48B-36	48"	37-3/8"	36.25"	CE60B-36	60"	37-3/8"	36.25"	CE72B-36	72"	37-3/8"	36.25"
CE48B-42	48"	37-3/8"	42.25"	CE60B-42	60"	37-3/8"	42.25"	CE72B-42	72"	37-3/8"	42.25"
CE48B-46	48"	37-3/8"	46.00"	CE60B-46	60"	37-3/8"	46.00"	CE72B-46	72"	37-3/8"	46.00"
CE48B-48	48"	37-3/8"	48.25"	CE60B-48	60"	37-3/8"	48.25"	CE72B-48	72"	37-3/8"	48.25"
CE48C-18	48"	41-3/8"	18.25"	CE60C-18	60"	41-3/8"	18.25"	CE72C-18	72"	41-3/8"	18.25"
CE48C-22	48"	41-3/8"	22.00"	CE60C-22	60"	41-3/8"	22.00"	CE72C-22	72"	41-3/8"	22.00"
CE48C-24	48"	41-3/8"	24.25"	CE60C-24	60"	41-3/8"	24.25"	CE72C-24	72"	41-3/8"	24.25"
CE48C-28	48"	41-3/8"	28.00"	CE60C-28	60"	41-3/8"	28.00"	CE72C-28	72"	41-3/8"	28.00"
CE48C-30	48"	41-3/8"	30.25"	CE60C-30	60"	41-3/8"	30.25"	CE72C-30	72"	41-3/8"	30.25"
CE48C-34	48"	41-3/8"	34.00"	CE60C-34	60"	41-3/8"	34.00"	CE72C-34	72"	41-3/8"	34.00"
CE48C-36	48"	41-3/8"	36.25"	CE60C-36	60"	41-3/8"	36.25"	CE72C-36	72"	41-3/8"	36.25"
CE48C-42	48"	41-3/8"	42.25"	CE60C-42	60"	41-3/8"	42.25"	CE72C-42	72"	41-3/8"	42.25"
CE48C-46	48"	41-3/8"	46.00"	CE60C-46	60"	41-3/8"	46.00"	CE72C-46	72"	41-3/8"	46.00"
CE48C-48	48"	41-3/8"	48.25"	CE60C-48	60"	41-3/8"	48.25"	CE72C-48	72"	41-3/8"	48.25"

FUME HOODS

Options & Accessories – Ceiling Enclosures

Fume Hood Ceiling Enclosures (cont'd)

- Provides a finished appearance and encloses the space from the top of the fume hood to the ceiling
- A removable front panel is provided for access
- Enclosure heights can be field trimmed as required
- Finished to match the fume hood

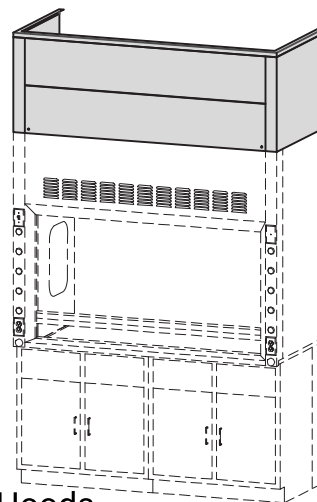

Ceiling Enclosures 5SA Benchtop Fume Hoods

Note: A verified ceiling height is required for manufacturing the correct height of enclosure

Model	Width	Depth	Height	Model	Width	Depth	Height
CE96A-18	96"	31-3/8"	18.25"	CE120A-18	120"	31-3/8"	18.25"
CE96A-22	96"	31-3/8"	22.00"	CE120A-22	120"	31-3/8"	22.00"
CE96A-24	96"	31-3/8"	24.25"	CE120A-24	120"	31-3/8"	24.25"
CE96A-28	96"	31-3/8"	28.00"	CE120A-28	120"	31-3/8"	28.00"
CE96A-30	96"	31-3/8"	30.25"	CE120A-30	120"	31-3/8"	30.25"
CE96A-34	96"	31-3/8"	34.00"	CE120A-34	120"	31-3/8"	34.00"
CE96A-36	96"	31-3/8"	36.25"	CE120A-36	120"	31-3/8"	36.25"
CE96A-42	96"	31-3/8"	42.25"	CE120A-42	120"	31-3/8"	42.25"
CE96A-46	96"	31-3/8"	46.00"	CE120A-46	120"	31-3/8"	46.00"
CE96A-48	96"	31-3/8"	48.25"	CE120A-48	120"	31-3/8"	48.25"
CE96B-18	96"	37-3/8"	18.25"	CE120B-18	120"	37-3/8"	18.25"
CE96B-22	96"	37-3/8"	22.00"	CE120B-22	120"	37-3/8"	22.00"
CE96B-24	96"	37-3/8"	24.25"	CE120B-24	120"	37-3/8"	24.25"
CE96B-28	96"	37-3/8"	28.00"	CE120B-28	120"	37-3/8"	28.00"
CE96B-30	96"	37-3/8"	30.25"	CE120B-30	120"	37-3/8"	30.25"
CE96B-34	96"	37-3/8"	34.00"	CE120B-34	120"	37-3/8"	34.00"
CE96B-36	96"	37-3/8"	36.25"	CE120B-36	120"	37-3/8"	36.25"
CE96B-42	96"	37-3/8"	42.25"	CE120B-42	120"	37-3/8"	42.25"
CE96B-46	96"	37-3/8"	46.00"	CE120B-46	120"	37-3/8"	46.00"
CE96B-48	96"	37-3/8"	48.25"	CE120B-48	120"	37-3/8"	48.25"
CE96C-18	96"	41-3/8"	18.25"	CE120C-18	120"	41-3/8"	18.25"
CE96C-22	96"	41-3/8"	22.00"	CE120C-22	120"	41-3/8"	22.00"
CE96C-24	96"	41-3/8"	24.25"	CE120C-24	120"	41-3/8"	24.25"
CE96C-28	96"	41-3/8"	28.00"	CE120C-28	120"	41-3/8"	28.00"
CE96C-30	96"	41-3/8"	30.25"	CE120C-30	120"	41-3/8"	30.25"
CE96C-34	96"	41-3/8"	34.00"	CE120C-34	120"	41-3/8"	34.00"
CE96C-36	96"	41-3/8"	36.25"	CE120C-36	120"	41-3/8"	36.25"
CE96C-42	96"	41-3/8"	42.25"	CE120C-42	120"	41-3/8"	42.25"
CE96C-46	96"	41-3/8"	46.00"	CE120C-46	120"	41-3/8"	46.00"
CE96C-48	96"	41-3/8"	48.25"	CE120C-48	120"	41-3/8"	48.25"

Floor-Mounted Fume Hood Ceiling Enclosures

- Provides a finished appearance and encloses the space from the top of the fume hood to the ceiling
- A removable front panel is provided for access
- Enclosure heights can be field trimmed as required
- Finished to match the fume hood

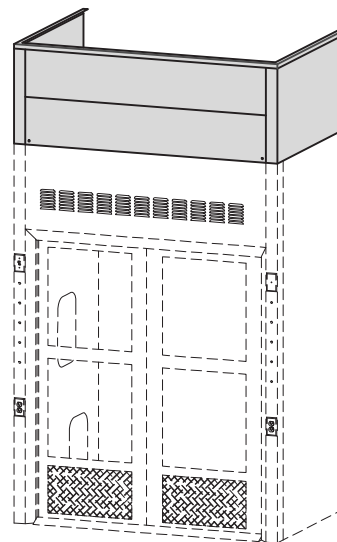

Model	Width	Depth	Height
CEWI48A-12	48"	36"	12.00"
CEWI48A-18	48"	36"	18.00"
CEWI48A-24	48"	36"	24.00"
CEWI48A-36	48"	36"	36.00"
CEWI48B-12	48"	47-1/2"	12.00"
CEWI48B-18	48"	47-1/2"	18.00"
CEWI48B-24	48"	47-1/2"	24.00"
CEWI48B-36	48"	47-1/2"	36.00"
CEWI60A-12	60"	36"	12.00"
CEWI60A-18	60"	36"	18.00"
CEWI60A-24	60"	36"	24.00"
CEWI60A-36	60"	36"	36.00"
CEWI60B-12	60"	47-1/2"	12.00"
CEWI60B-18	60"	47-1/2"	18.00"
CEWI60B-24	60"	47-1/2"	24.00"
CEWI60B-36	60"	47-1/2"	36.00"
CEWI72A-12	72"	36"	12.00"
CEWI72A-18	72"	36"	18.00"
CEWI72A-24	72"	36"	24.00"
CEWI72A-36	72"	36"	36.00"
CEWI72B-12	72"	47-1/2"	12.00"
CEWI72B-18	72"	47-1/2"	18.00"
CEWI72B-24	72"	47-1/2"	24.00"
CEWI72B-36	72"	47-1/2"	36.00"

Model	Width	Depth	Height
CEWI96A-12	96"	36"	12.00"
CEWI96A-18	96"	36"	18.00"
CEWI96A-24	96"	36"	24.00"
CEWI96A-36	96"	36"	36.00"
CEWI96B-12	96"	47-1/2"	12.00"
CEWI96B-18	96"	47-1/2"	18.00"
CEWI96B-24	96"	47-1/2"	24.00"
CEWI96B-36	96"	47-1/2"	36.00"
CEWI120A-12	120"	36"	12.00"
CEWI120A-18	120"	36"	18.00"
CEWI120A-24	120"	36"	24.00"
CEWI120A-36	120"	36"	36.00"
CEWI120B-12	120"	47-1/2"	12.00"
CEWI120B-18	120"	47-1/2"	18.00"
CEWI120B-24	120"	47-1/2"	24.00"
CEWI120B-36	120"	47-1/2"	36.00"
CEWI144A-12	144"	36"	12.00"
CEWI144A-18	144"	36"	18.00"
CEWI144A-24	144"	36"	24.00"
CEWI144A-36	144"	36"	36.00"
CEWI144B-12	144"	47-1/2"	12.00"
CEWI144B-18	144"	47-1/2"	18.00"
CEWI144B-24	144"	47-1/2"	24.00"
CEWI144B-36	144"	47-1/2"	36.00"

FUME HOODS

Options & Accessories – Extractor Arms

Fume Extractor Arms

- A localized fume extractor with articulated joints lets you position the exhaust where you need it
- Available in wall, ceiling, or bench top mounting bracket options
- Extractors must be connected to a building exhaust system
- For more information on sizes and styles, contact your HLS representative

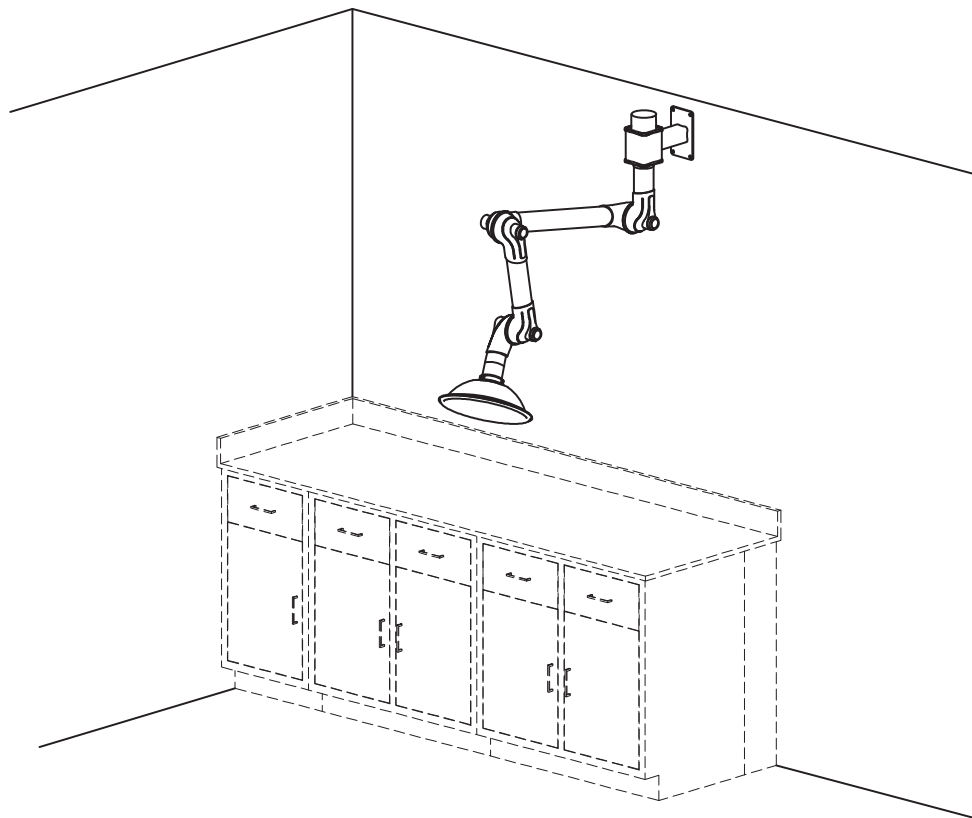

Island Mounted Canopy Hoods

- Canopy hoods are designed to exhaust heat, steam, or odors when mounted over laboratory benches above equipment
- Manufactured from 18 ga. cold rolled steel with the same chemical resistant finish as the HLS casework or with stainless steel construction
- Connecting ductwork is not included
- Threaded rods are included for installation to the ceiling structure
- For stainless steel construction, add -SS at the end of the model number

Island Mounted Canopy Hoods

Model	Width	Depth	Height	Style
CHI3624-12	36"	24"	12"	Island
CHI3624-18	36"	24"	18"	Island
CHI3624-24	36"	24"	24"	Island
CHI3630-12	36"	30"	12"	Island
CHI3630-18	36"	30"	18"	Island
CHI3630-24	36"	30"	24"	Island
CHI3636-12	36"	36"	12"	Island
CHI3636-18	36"	36"	18"	Island
CHI3636-24	36"	36"	24"	Island
CHI4824-12	48"	24"	12"	Island
CHI4824-18	48"	24"	18"	Island
CHI4824-24	48"	24"	24"	Island
CHI4830-12	48"	30"	12"	Island
CHI4830-18	48"	30"	18"	Island
CHI4830-24	48"	30"	24"	Island
CHI4836-12	48"	36"	12"	Island
CHI4836-18	48"	36"	18"	Island
CHI4836-24	48"	36"	24"	Island
CHI5824-12	58"	24"	12"	Island
CHI5824-18	58"	24"	18"	Island
CHI5824-24	58"	24"	24"	Island
CHI5830-12	58"	30"	12"	Island
CHI5830-18	58"	30"	18"	Island
CHI5830-24	58"	30"	24"	Island
CHI5836-12	58"	36"	12"	Island
CHI5836-18	58"	36"	18"	Island
CHI5836-24	58"	36"	24"	Island
CHI7224-12	72"	24"	12"	Island
CHI7224-18	72"	24"	18"	Island
CHI7224-24	72"	24"	24"	Island
CHI7230-12	72"	30"	12"	Island
CHI7230-18	72"	30"	18"	Island
CHI7230-24	72"	30"	24"	Island
CHI7236-12	72"	36"	12"	Island
CHI7236-18	72"	36"	18"	Island
CHI7236-24	72"	36"	24"	Island

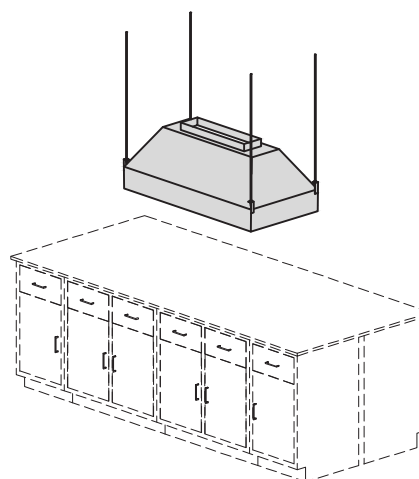

FUME HOODS

Options & Accessories – Canopy Hoods

Wall Mounted Canopy Hoods

- Canopy hoods are designed to exhaust heat, steam, or odors when mounted over laboratory benches above equipment
- Manufactured from 18 ga. cold rolled steel with the same chemical resistant finish as the HLS casework or with stainless steel construction
- Connecting ductwork is not included
- Threaded rods are included for installation to the ceiling structure
- For stainless steel construction, add -SS at the end of the model number

Wall Mounted Canopy Hoods

Model	Width	Depth	Height	Style
CHW3624-12	36"	24"	12"	Wall
CHW3624-18	36"	24"	18"	Wall
CHW3624-24	36"	24"	24"	Wall
CHW3630-12	36"	30"	12"	Wall
CHW3630-18	36"	30"	18"	Wall
CHW3630-24	36"	30"	24"	Wall
CHW3636-12	36"	36"	12"	Wall
CHW3636-18	36"	36"	18"	Wall
CHW3636-24	36"	36"	24"	Wall
CHW4824-12	48"	24"	12"	Wall
CHW4824-18	48"	24"	18"	Wall
CHW4824-24	48"	24"	24"	Wall
CHW4830-12	48"	30"	12"	Wall
CHW4830-18	48"	30"	18"	Wall
CHW4830-24	48"	30"	24"	Wall
CHW4836-12	48"	36"	12"	Wall
CHW4836-18	48"	36"	18"	Wall
CHW4836-24	48"	36"	24"	Wall
CHW5824-12	58"	24"	12"	Wall
CHW5824-18	58"	24"	18"	Wall
CHW5824-24	58"	24"	24"	Wall
CHW5830-12	58"	30"	12"	Wall
CHW5830-18	58"	30"	18"	Wall
CHW5830-24	58"	30"	24"	Wall
CHW5836-12	58"	36"	12"	Wall
CHW5836-18	58"	36"	18"	Wall
CHW5836-24	58"	36"	24"	Wall
CHW7224-12	72"	24"	12"	Wall
CHW7224-18	72"	24"	18"	Wall
CHW7224-24	72"	24"	24"	Wall
CHW7230-12	72"	30"	12"	Wall
CHW7230-18	72"	30"	18"	Wall
CHW7230-24	72"	30"	24"	Wall
CHW7236-12	72"	36"	12"	Wall
CHW7236-18	72"	36"	18"	Wall
CHW7236-24	72"	36"	24"	Wall

